

MAP OF A SURVEY FOR ROBERT M. & LOIS J. STIVERSON BEING PART OF ORIGINAL LOTS No. 127 & No. 132, TRACT No. 3 CITY OF CHARDON ~ GEauga COUNTY ~ OHIO

Wintersgreen Hills Subdivision #2 Vol. 9 Pg. 92

RECEIVED ENGINEER GEORGE W. WALKER DEC 03 2003



I certify this survey is in accordance with the provisions of Chapter 4733-37 of the Ohio Administrative Code
J. Arthur Temple
Registered Surveyor #4761
August 2003

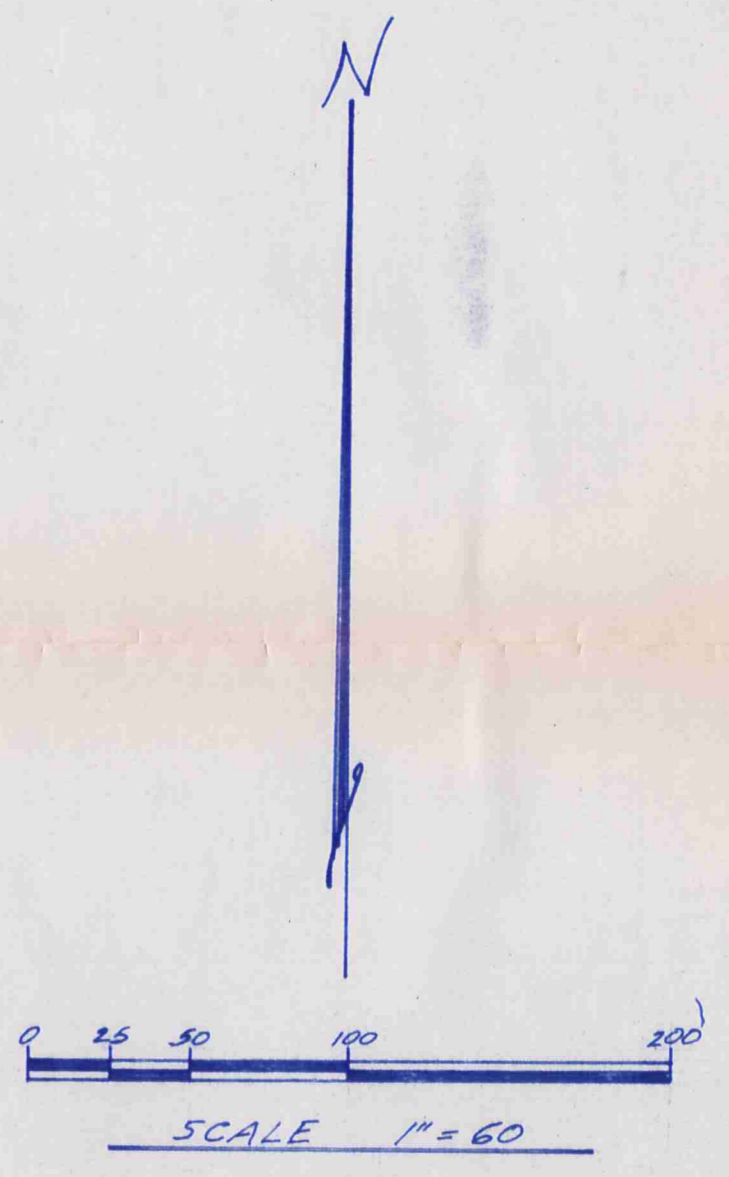
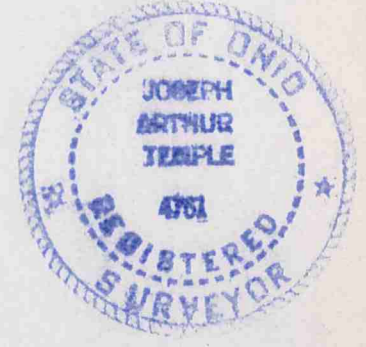

NOTE: Bearings shown here on are based on an assumed meridian and are used to indicate angles only.

JK Revised 12/03/03
OFFICE OF THE
GEAUGA COUNTY ENGINEER

**DESCRIPTION FOR
GILLETTE
2.688 Acres**

Situated in the City of Chardon, County of Geauga and State of Ohio, being part of Original Lot Nos. 127 & 132, Tract No. 3, within said city and further described as follows:

Beginning in the north margin of Canfield Drive at a 3/4 inch iron pipe found at the southwest corner of land conveyed to Mark L. and Eileen M. Adkins by deed recorded in Vol. 1360, Pg. 627 of the Geauga County Records of Deeds, said point of beginning being referenced by a 3/4 inch iron pipe found at an angle point in the margin of Canfield Drive as shown on the plat of Canfield Drive as recorded in Vol. 9, Pg. 95 of the Geauga County Records of Plats, and being North 63° 13' 35" East along said Canfield Drive margin a distance of 51.29 feet therefrom;

Thence South 63° 13' 35" West along the north margin of Canfield Drive a distance of 40.00 feet to a 5/8 iron pin set;

Thence North 04° 42' 20" West a distance of 202.08 feet to a 5/8 inch iron pin set;

Thence North 02° 25' 25" East a distance of 422.73 feet to a 5/8 inch iron pin set;

Thence North 50° 57' 10" West a distance of 194.12 feet to a 5/8 inch iron pin set in the east line of land conveyed to Anna May Hoffstetter by deed recorded in Vol. 1539, Pg. 481 of the Geauga County Records of Deeds;

Thence North 03° 55' 30" East along the east line of the said Hoffstetter land a distance of 135.52 feet to a 5/8 inch iron pin found;

Thence South 84° 28' 10" East a distance of 378.14 feet to a 5/8 inch iron pin set in the west line of land conveyed to Clifford and Janet L. Arko by deed recorded in Vol. 817, Pg. 323 of the Geauga County Records of Deeds;

Thence South 03° 53' 20" West along the west line of the said Arko land a distance of 236.47 feet to a 3/4 inch iron pipe found at the northeast corner of the aforementioned Adkins land;

Thence North 86° 06' 40" West along the north line of the said Adkins land a distance of 159.35 feet to a 3/4 inch iron pipe found at the northwest corner thereof;

Thence South 02° 25' 25" West along the west line of the said Adkins land a distance of 602.20 feet to the place of beginning, containing within said bounds 2.688 acres of land, according to the survey of J. Arthur Temple, Registered Surveyor No. 4761 dated August 2003.

Bearings shown herein are based on an assumed meridian and are used to indicate angles only.

Previous recording: Vol. 860, Pg. 287.

Signed: *J. Arthur Temple*

Date: *Aug 2003*

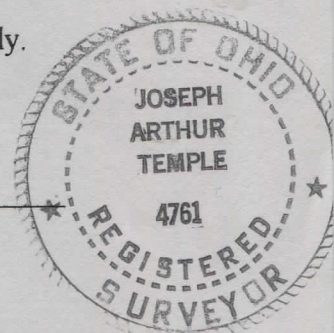

CHC00052

Gillette
picked up 12/14/03

**DESCRIPTION FOR
GILLETTE
2.000 Acres**

Situated in the City of Chardon, County of Geauga and State of Ohio, being part of Original Lot Nos. 127 & 132, Tract No. 3, within said city and further described as follows:

Beginning in the north margin of Canfield Drive at a 5/8 inch iron pin set at a point which is South 63° 13' 35" West along said road margin a distance of 40.00 from the southwest corner of land conveyed to Mark L. and Eileen M. Adkins by deed recorded in Vol. 1360, Pg. 627 of the Geauga County Records of Deeds, said point of beginning also being referenced by a 3/4 inch iron pipe found at an angle point in the margin of Canfield Drive as shown on the plat of Canfield Drive as recorded in Vol. 9, Pg. 95 of the Geauga County Records of Plats, and being North 63° 13' 35" East along said Canfield Drive margin a distance of 91.29 feet from said place of beginning;

Thence South 63° 13' 35" West along the north margin of Canfield Drive a distance of 110.00 feet to a 3/4 iron pipe found at the southeast corner of land conveyed to John M. and Mary E. Paranih by deed recorded in Vol. 732, Pg. 793 of the Geauga County Records of Deeds;

Thence North 04° 42' 20" West along the east line of the said Paranih land and along the east line of land conveyed to Brian P. and Unnim Heineking by deed recorded in Vol. 903, Pg. 993 of the Geauga County Records of Deeds and along the east line of land conveyed to Jan A. Sopko by deed recorded in Vol. 1090, Pg. 1134 of the Geauga County Records of Deeds a total distance of 703.70 feet to a 3/4 inch iron pipe found at the southeast corner of land conveyed to Anna May Hoffstetter by deed recorded in Vol. 1539, Pg. 481 of the Geauga County Records of Deeds;

Thence North 03° 55' 30" East along the east line of the said Hoffstetter land a distance of 94.48 feet to a 5/8 inch iron pin set;

Thence South 50° 57' 10" East a distance of 194.12 feet to a 5/8 inch iron pin set;

Thence South 02° 25' 25" West a distance of 422.73 feet to a 5/8 inch iron pin set;

Thence South 04° 42' 20" East a distance of 202.08 feet to the place of beginning, containing within said bounds 2.000 acres of land, according to the survey of J. Arthur Temple, Registered Surveyor No. 4761 dated August 2003.

Bearings shown herein are based on an assumed meridian and are used to indicate angles only.

Previous recording: Vol. 860, Pg. 287.

Signed: J. Arthur Temple

Date: Aug 2003

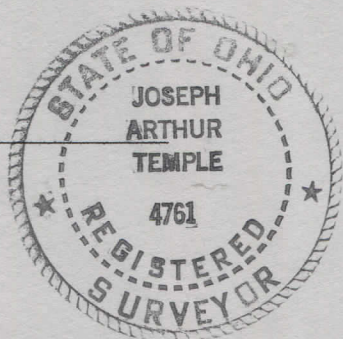

SURVEY PLAT & LEGAL DESCRIPTION
APPROVED PER R.C. 315.251

JK Reviewed 12/03/03
OFFICE OF THE
GEAUGA COUNTY ENGINEER